

# adjustable thin plaster ring Ø38

## installation instruction

1

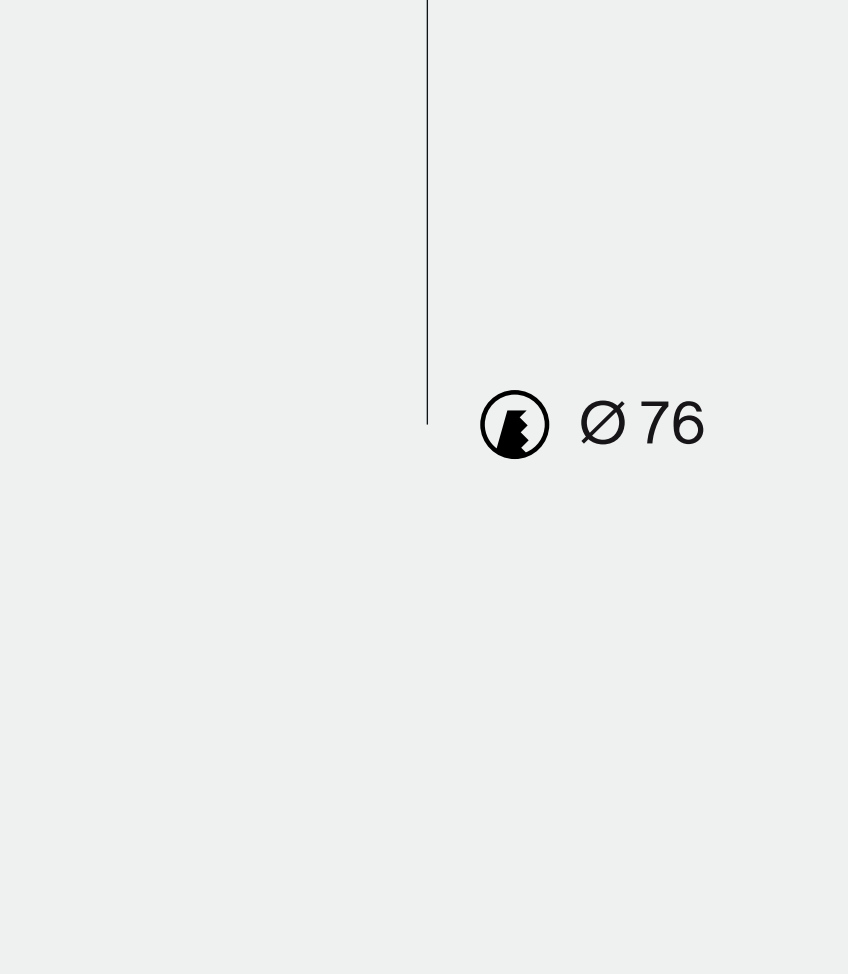

Cut a round hole (Ø 76). Consult the chosen luminaire tech specs for required height and free air dimensions.

2

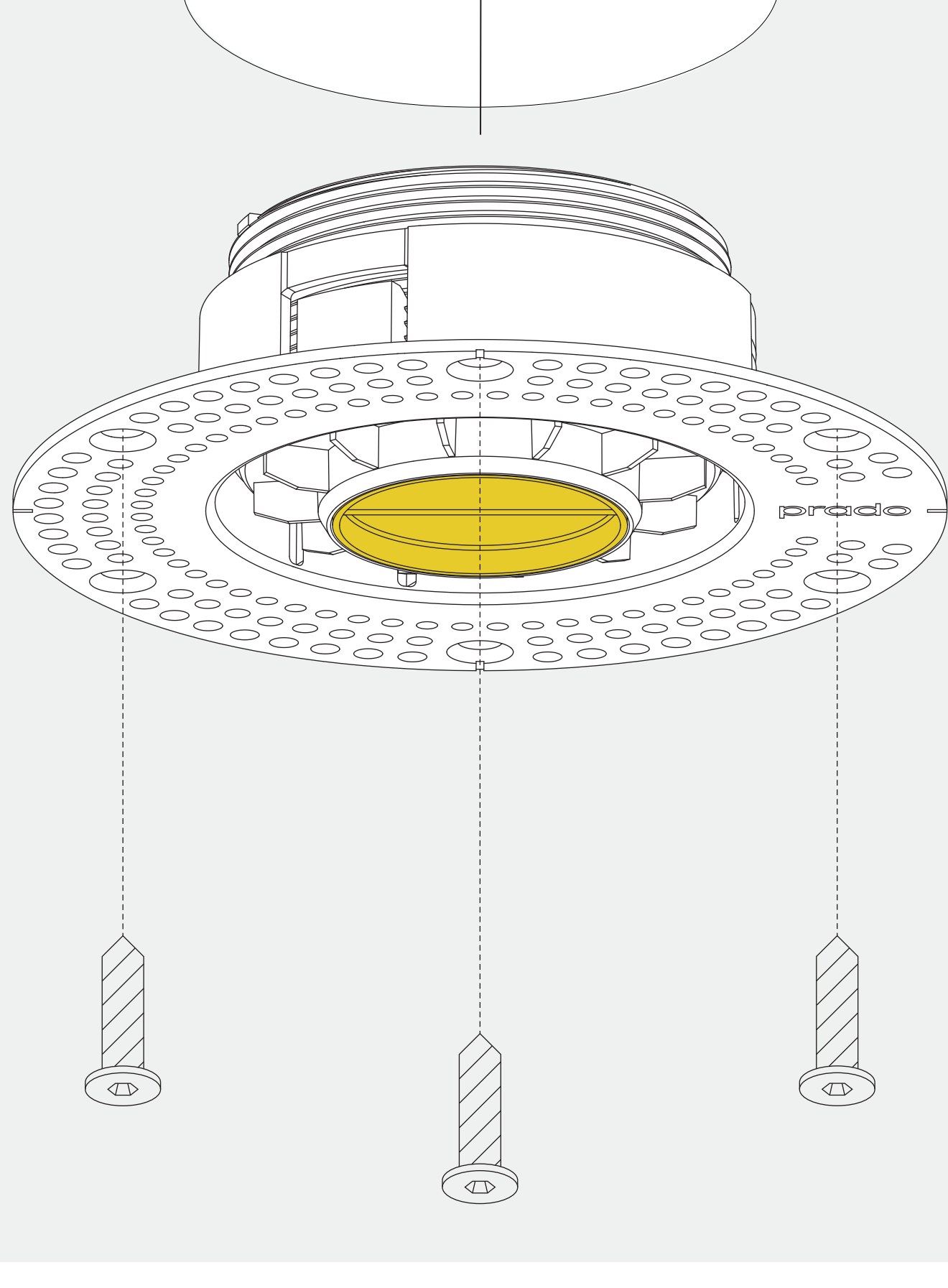

Insert the plaster ring and securely fasten it with glue or the appropriate screws on a screwfast surface. The attachment must be able to obtain a static load of 5 kg. It's the installers responsibility to ensure optimal attachment.

3

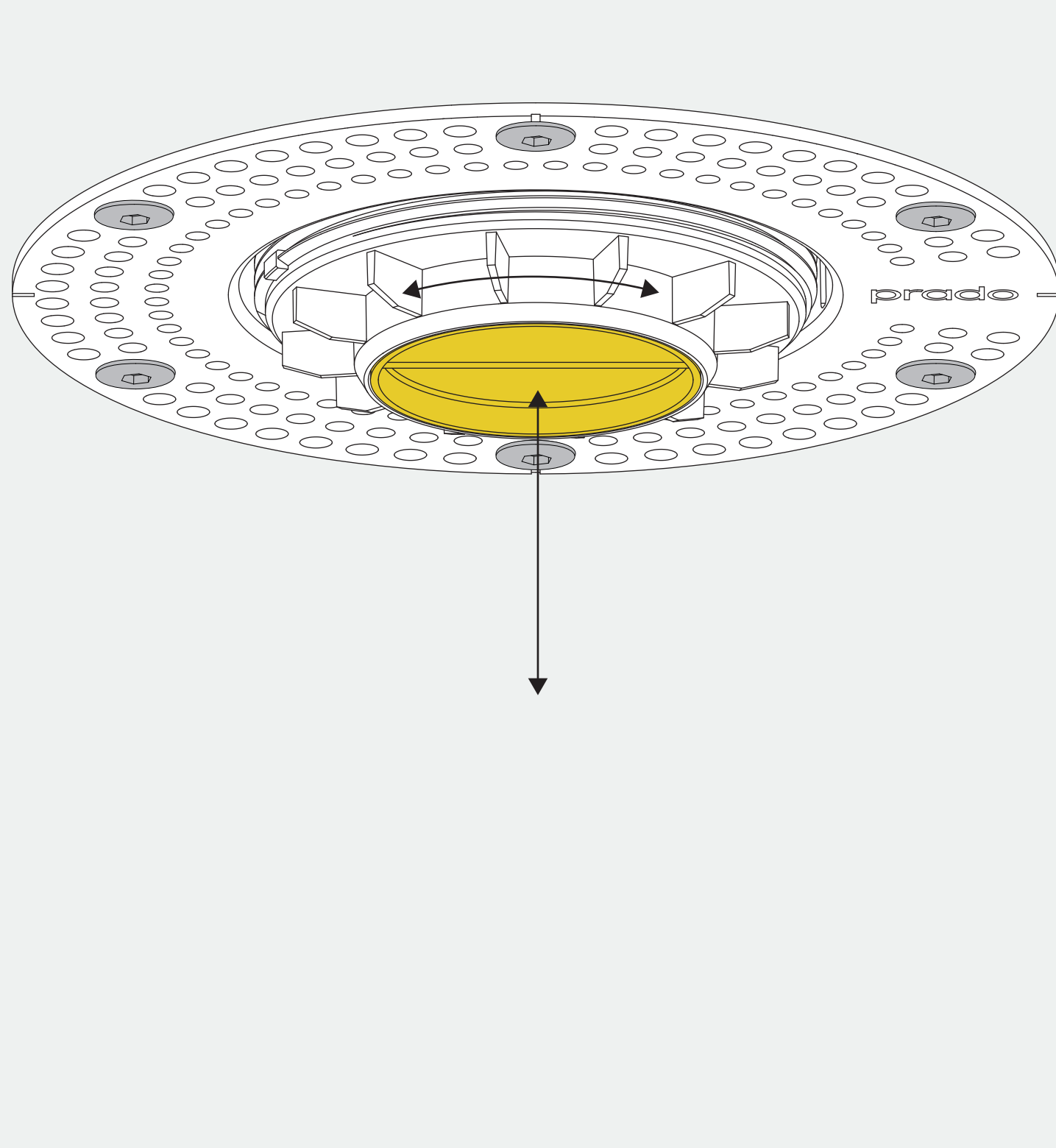

Adjust the height of the plaster ring by twisting the inner part of the kit (min. 3.6mm - max. 20mm).

4

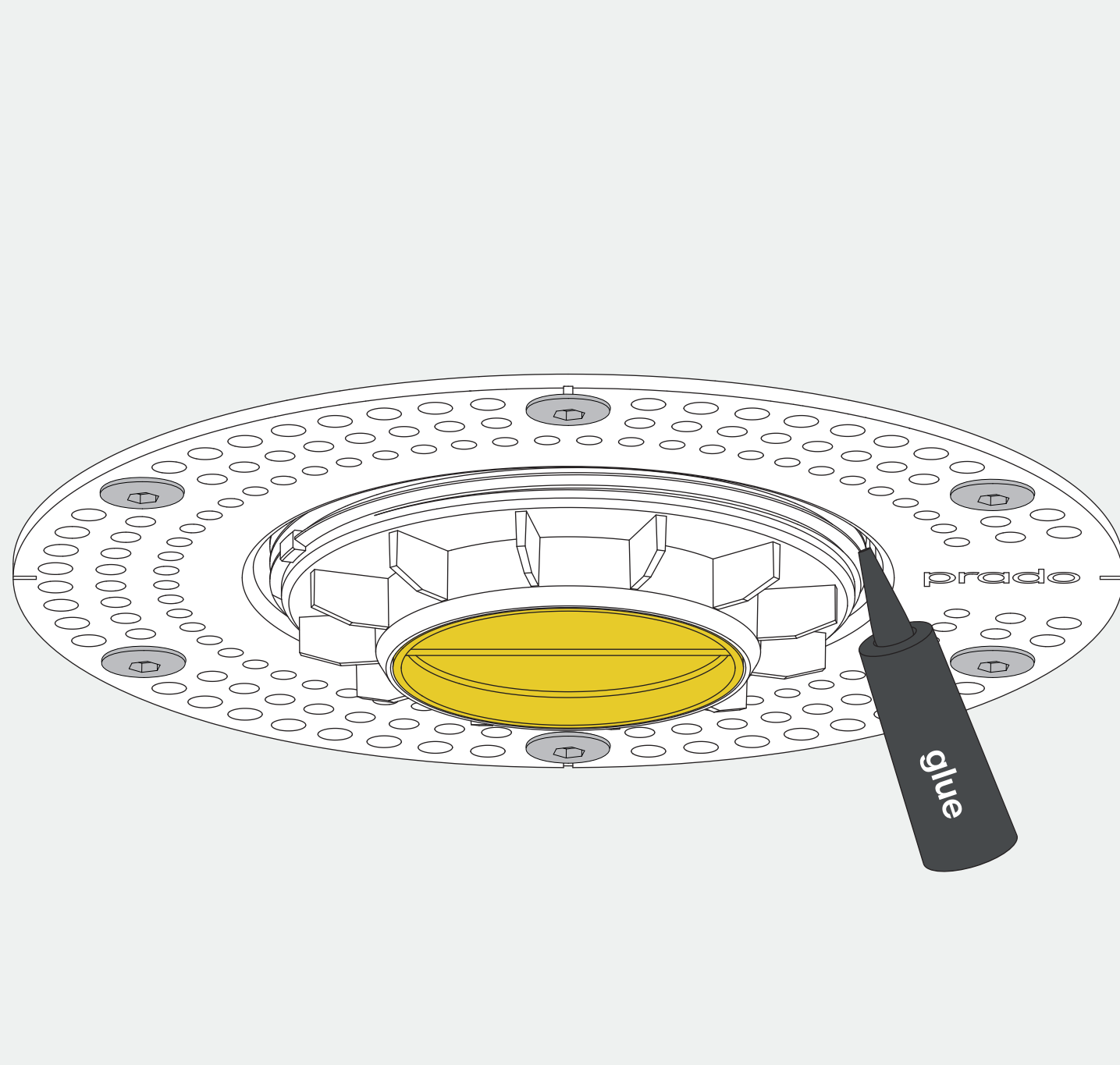

Fixate the inner part with the appropriate glue.

5

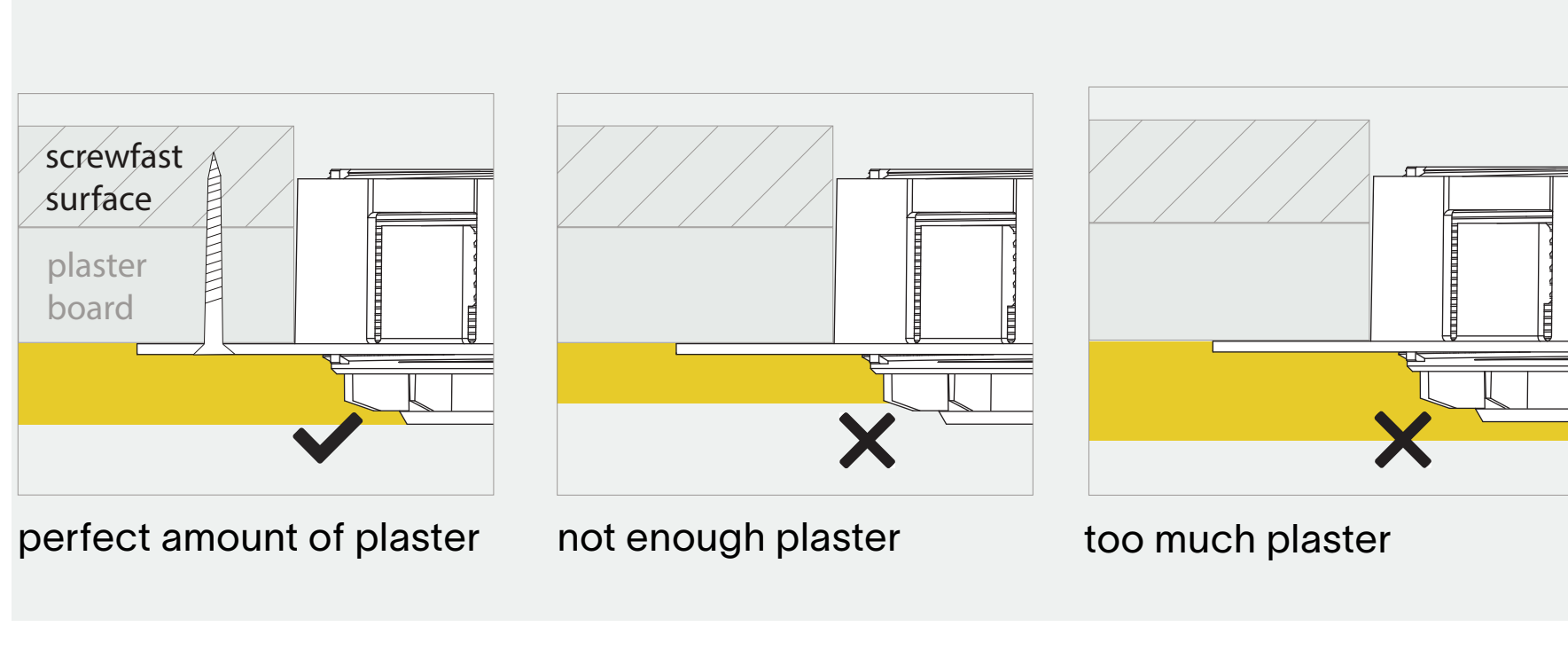
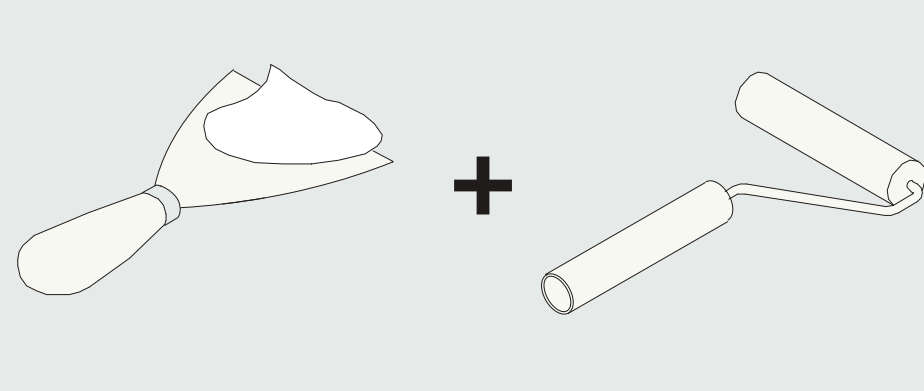
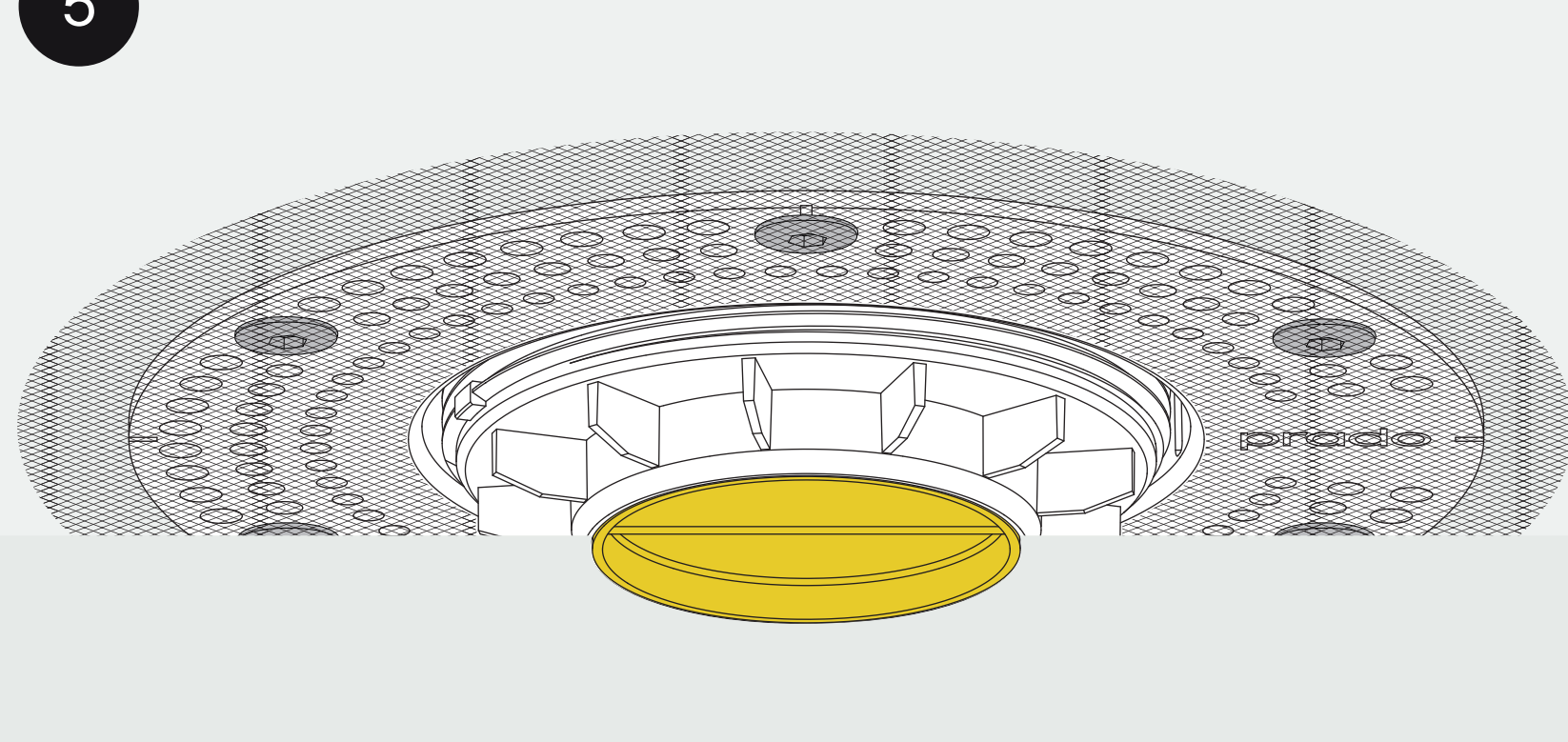

Excercise caution while plasing, do not damage the ring. Keep the plaster lid inside the plaster ring while plastering. Use a fiberglass mesh tape for optimal plaster adhesion. Make sure not to touch the edge of the ring when sanding.

6

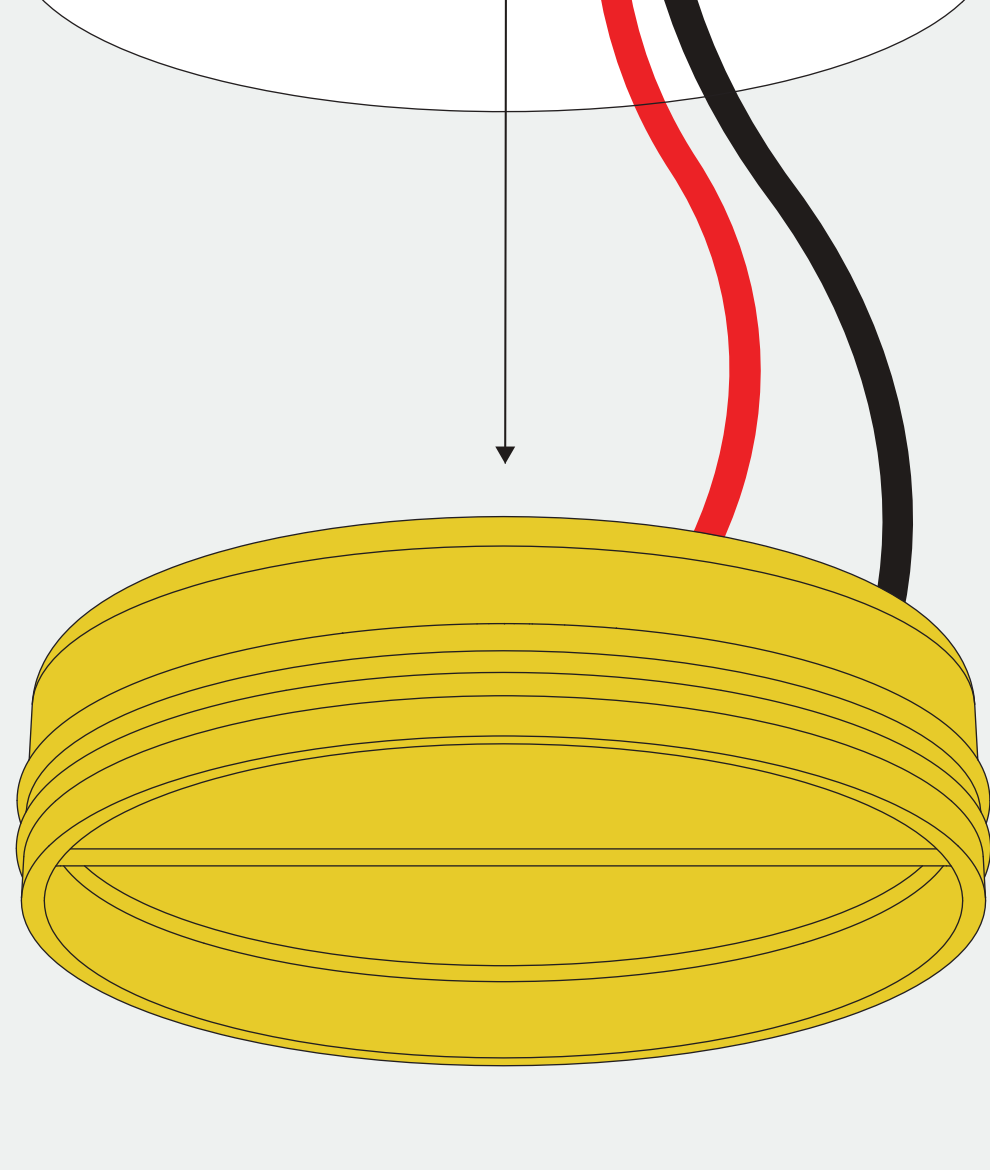

Remove the plaster lid before installing the fixture. Any residue needs to be removed without damaging the edges of the ring.

thank you for choosing prado

prado.eu

Installation must be done by skilled professionals only and instructions must be followed at all times. Warranty will not apply in case of wrongful use of if unskilled personnel attempts to repair a product.