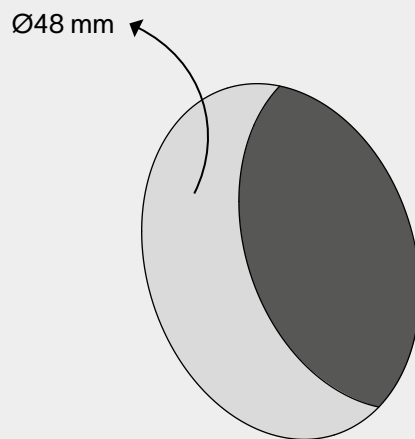

multifit holder/socket

installation instruction

1

Drill a Ø48 mm hole.

2

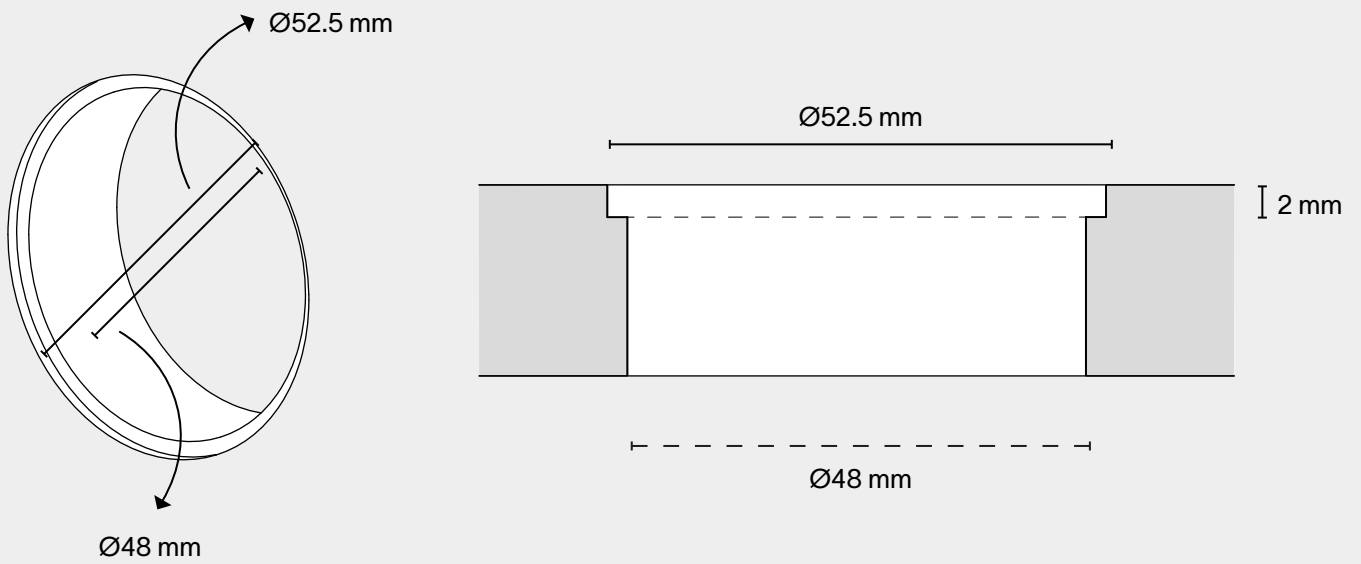

Optional flush mount countersink.

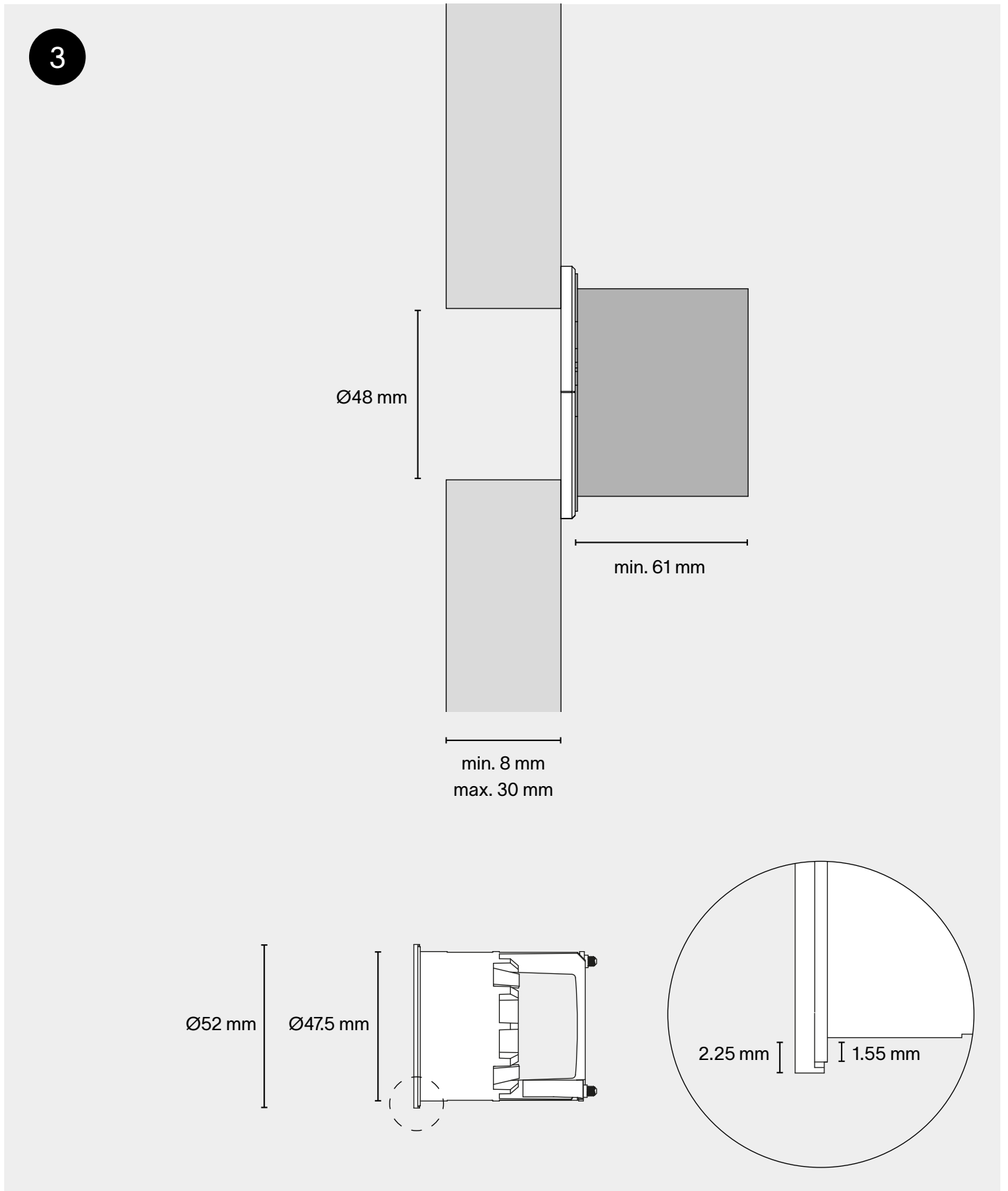

Installation specs.

4

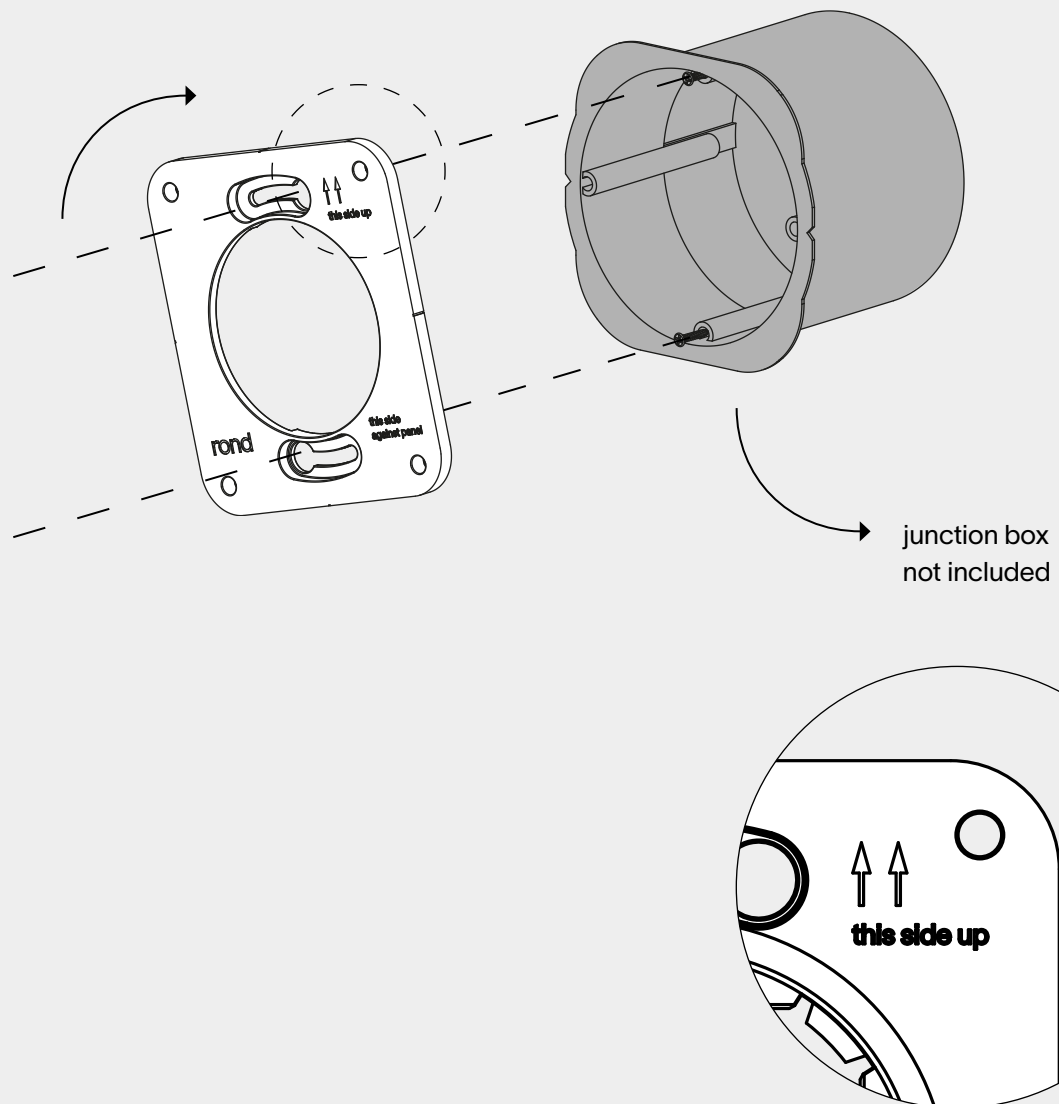

Place the junction box mounting plate on top of the junction box, give it a twist, and tighten the screws.

5

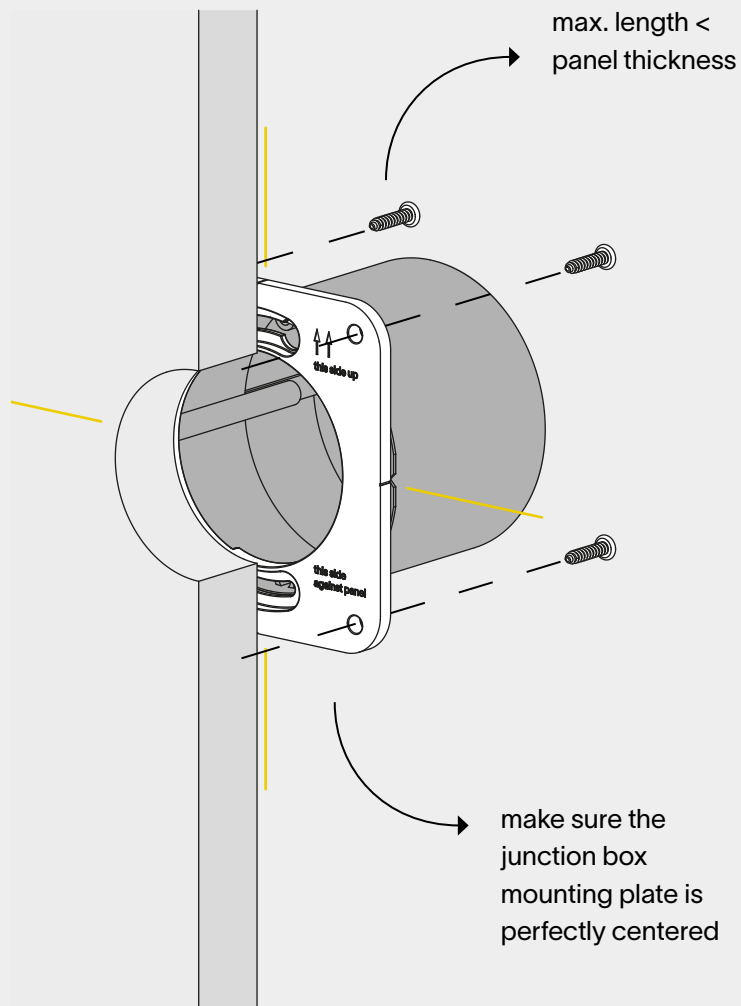

Fasten the junction box with junction box mounting plate at the back of the material. Screw on a screwfast surface or use the appropriate glue, compatible with both the panel material and the junction box mounting plate (PP + 30%GF). Make sure the correct side is facing up.

6

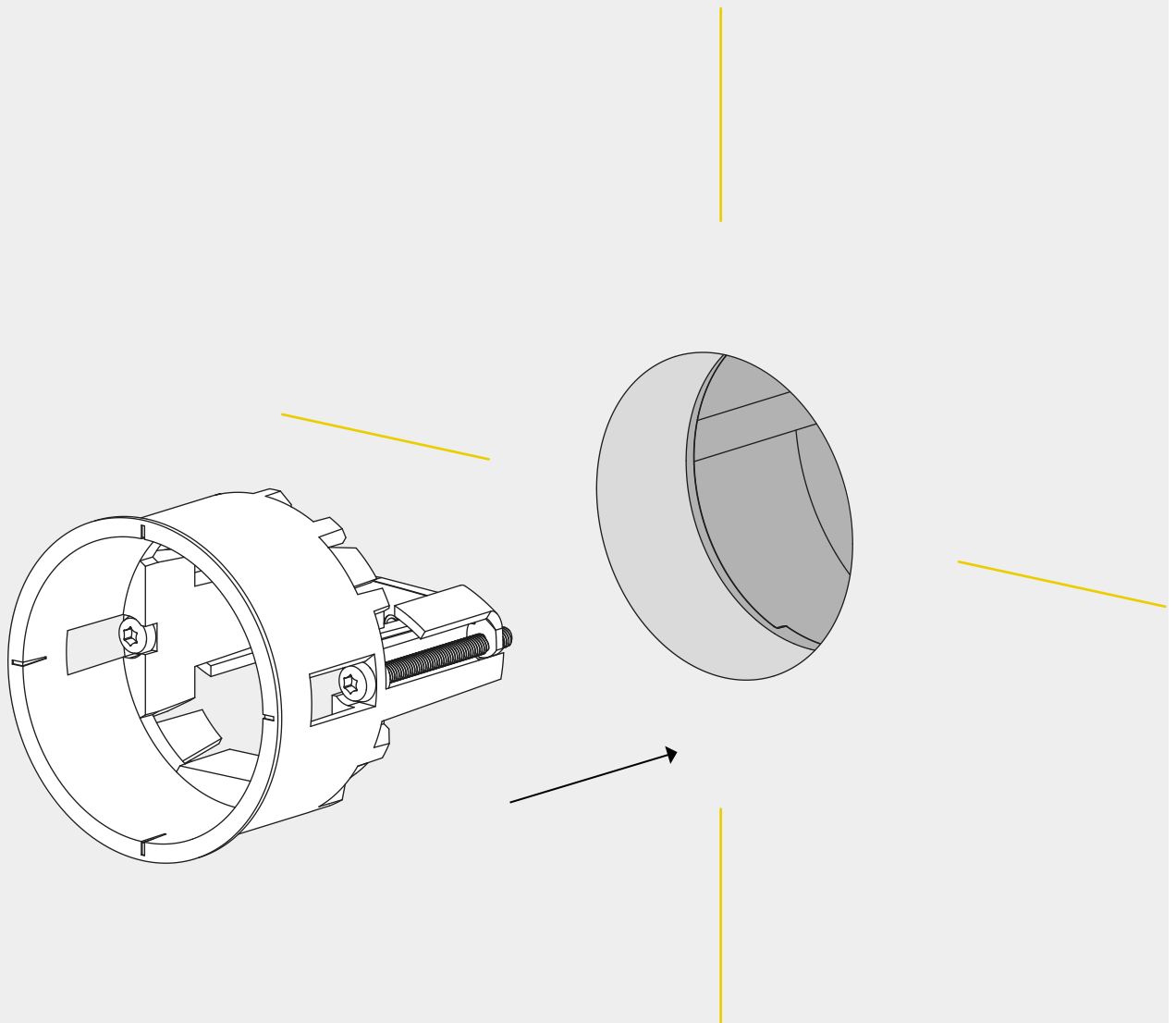

Position the multifit holder in the hole.

7

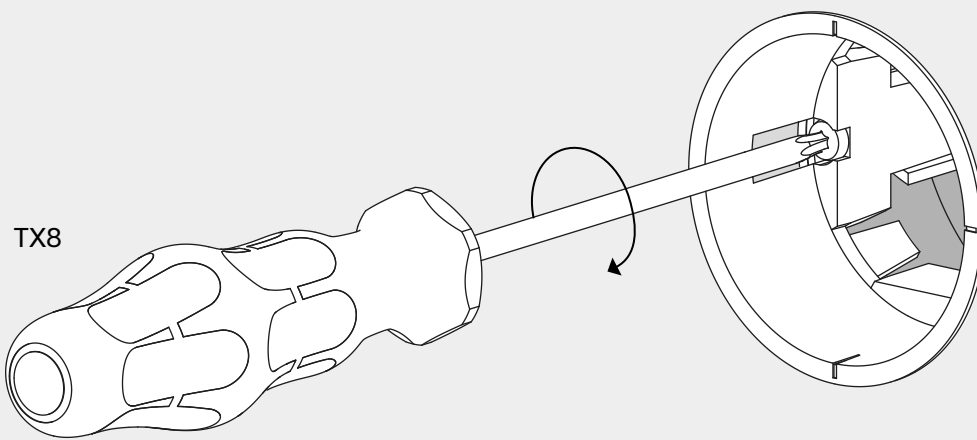

1

2

3

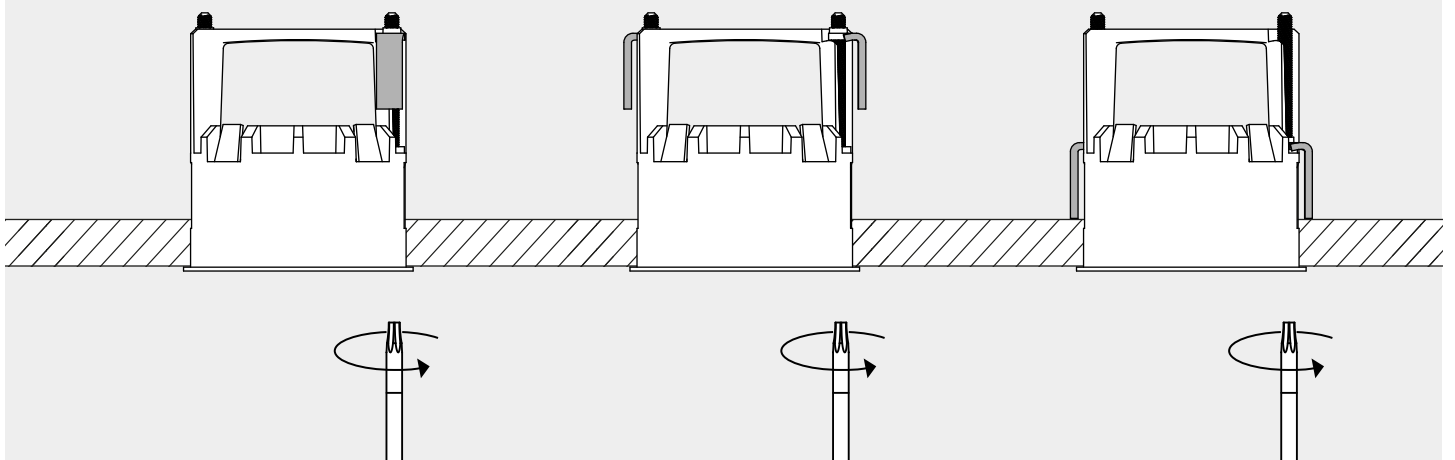

Use the notches in the multifit holder to level it. Now fix the multifit holder until the clamps are tightened against the wall.

8

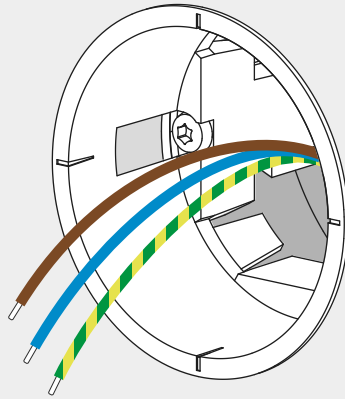

Pull the wires through.

9

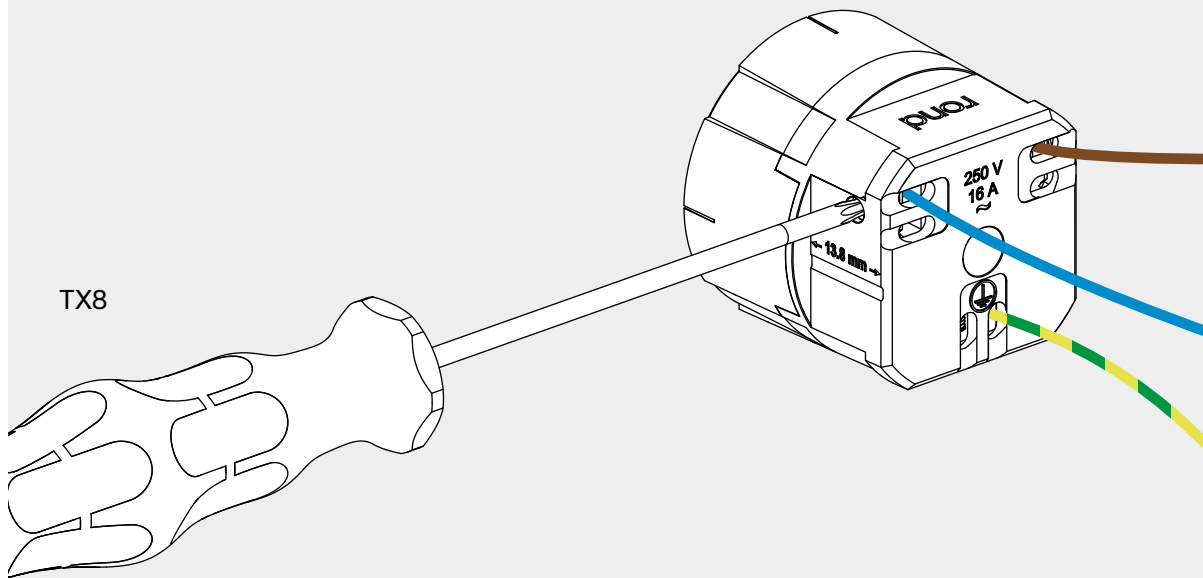

13.8 mm



Attach the wires to the socket.

10

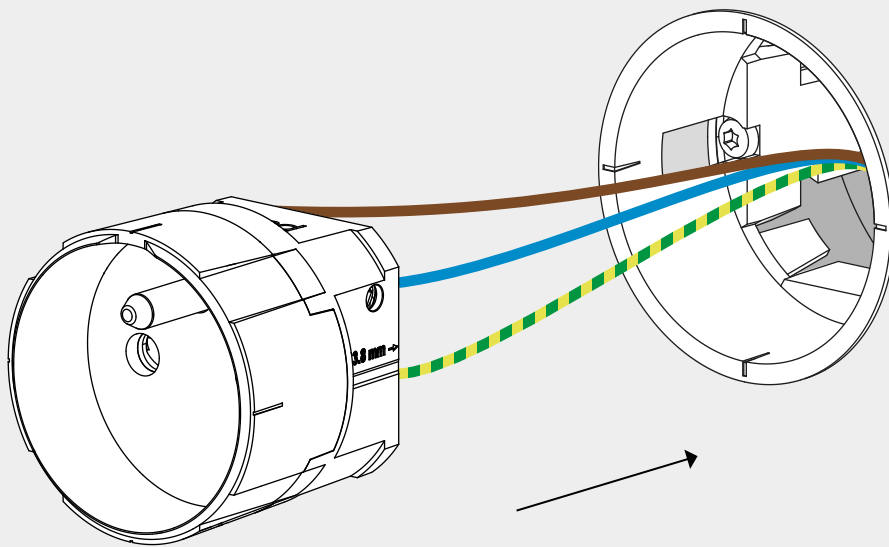

Push the socket into the multifit holder.

11

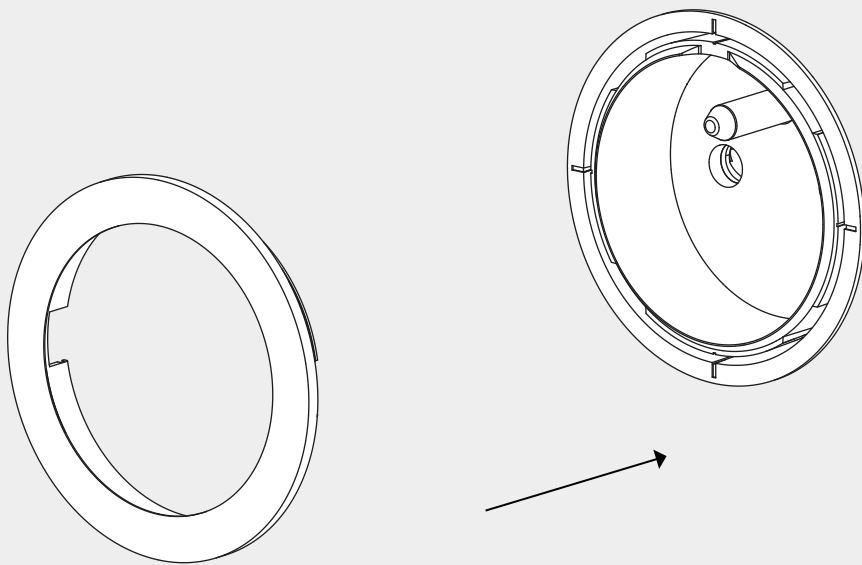

Install the showering.

12

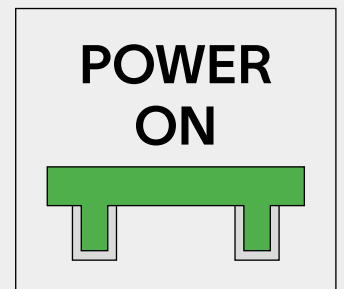
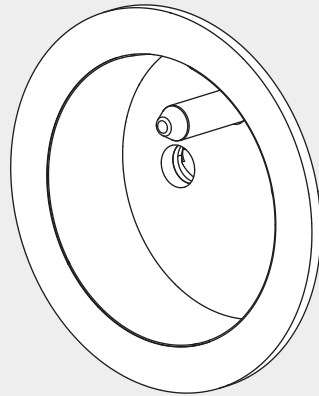

Turn the power back on.

1

for removal

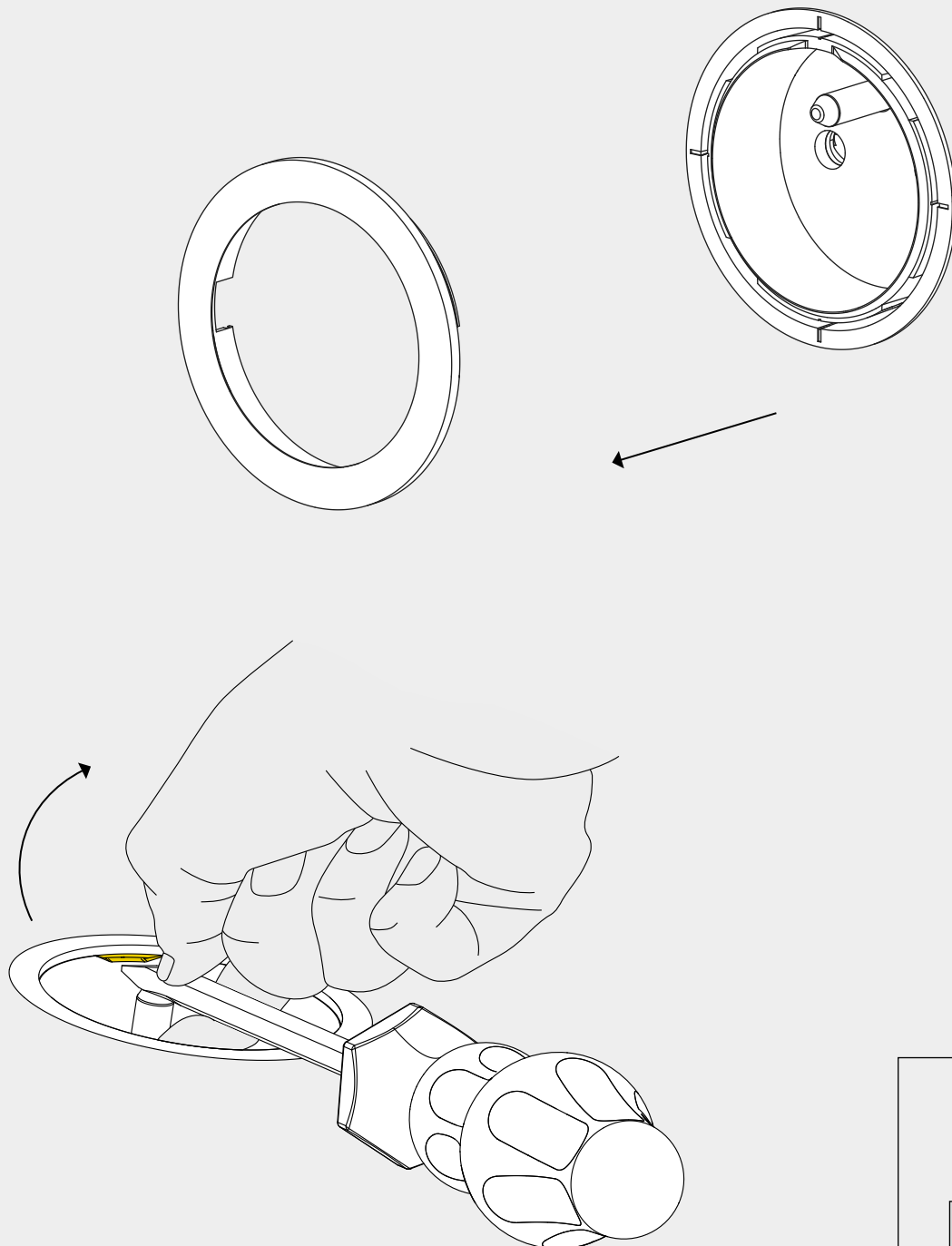

Remove the showering with a flat screwdriver.

2

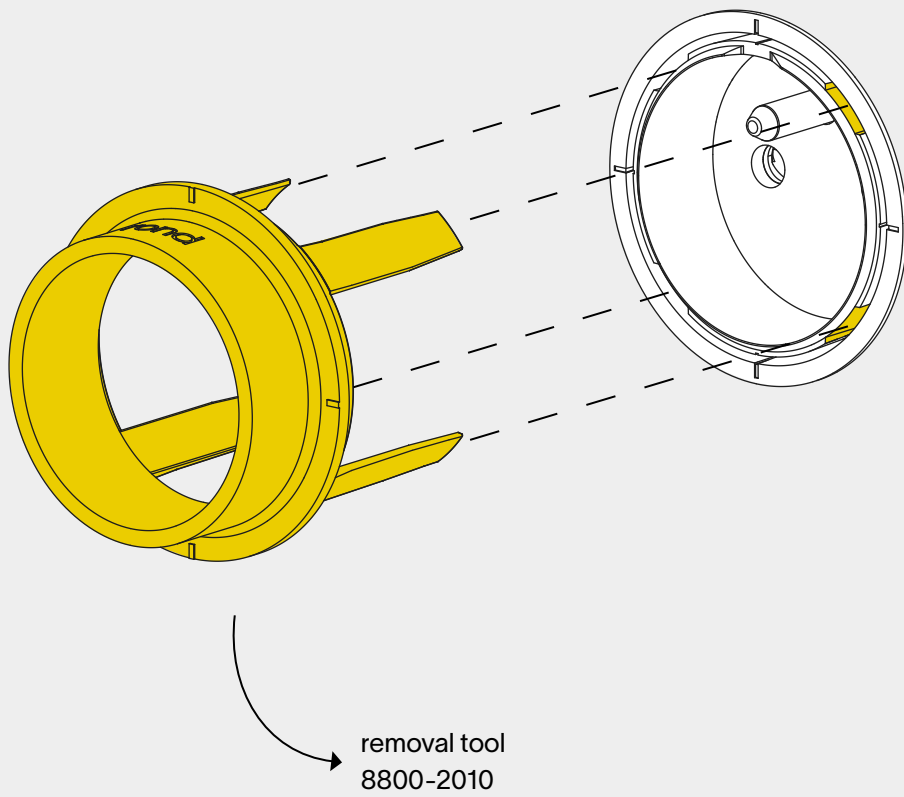

Put the removal tool into the socket.

3

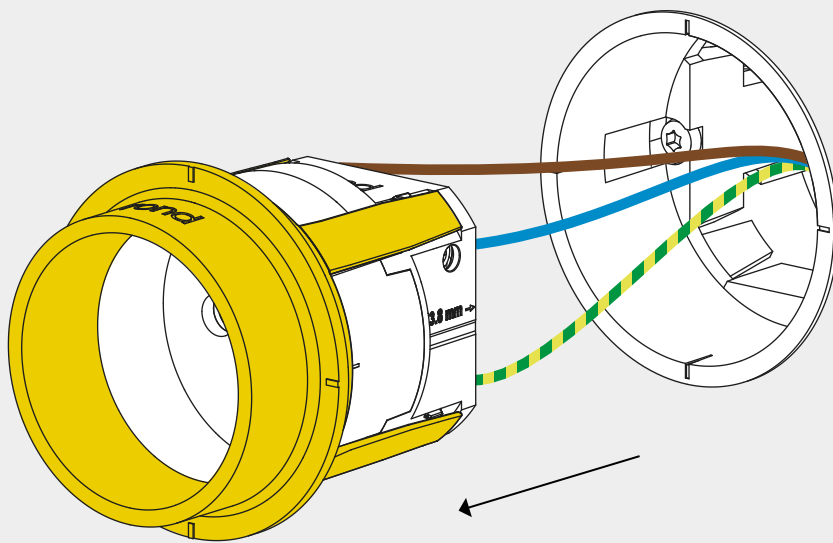

Pull out the socket.

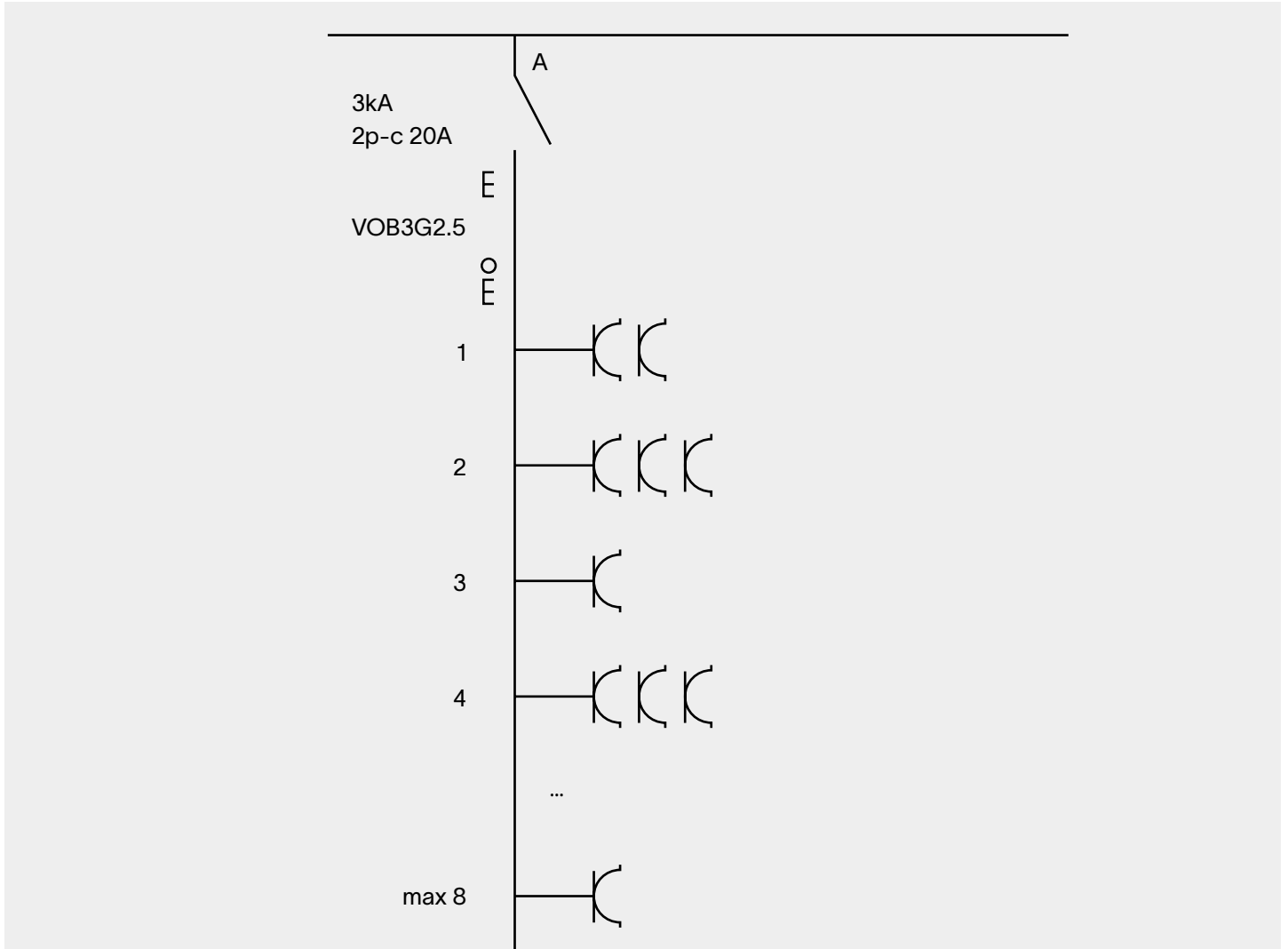

Socket model scheme.

thank you for choosing rond

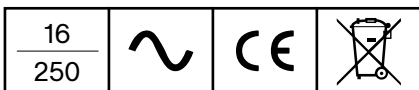

rond.io

Shiver NV - Handelsstraat 19 - 8630 Veurne - Belgium

Installation must be done by skilled professionals only and instructions must be followed at all times. Warranty will not apply in case of wrongful use or if unskilled personnel attempts to repair a product.