

plaster ring jack installation instruction

1

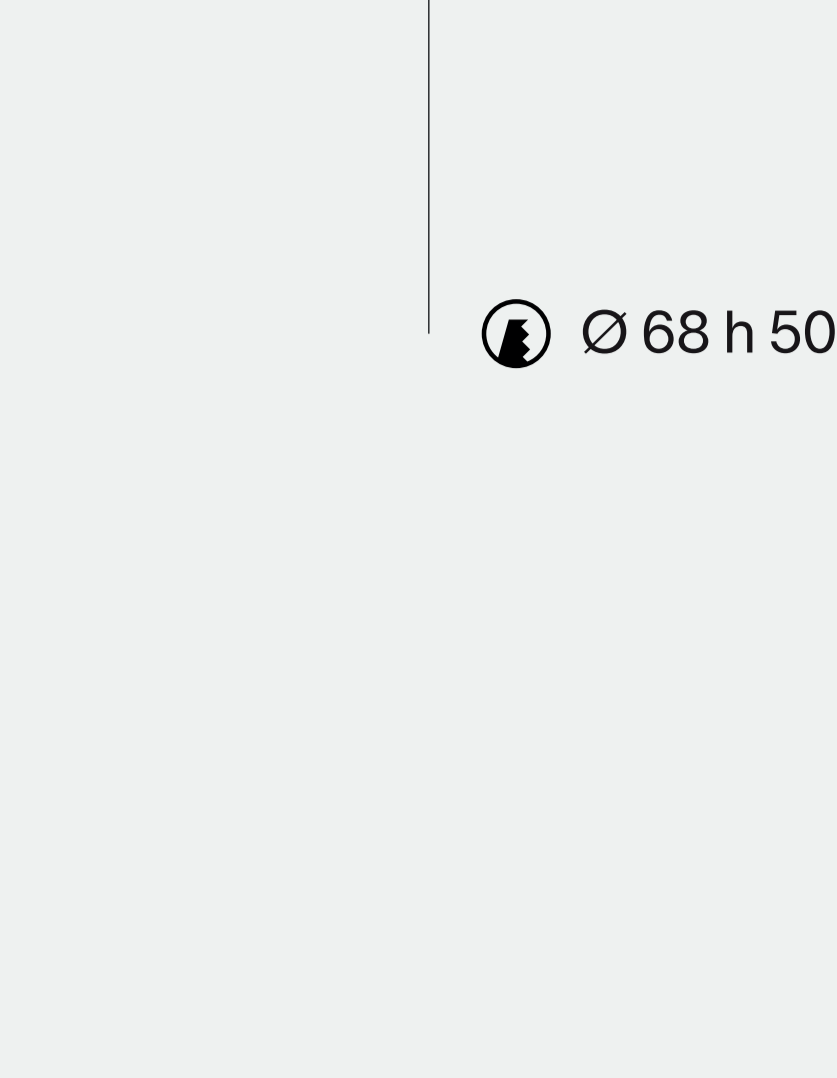

Cut a round hole (Ø 68 h 50)
Suited for indoor, non-sloped ceilings only.

2

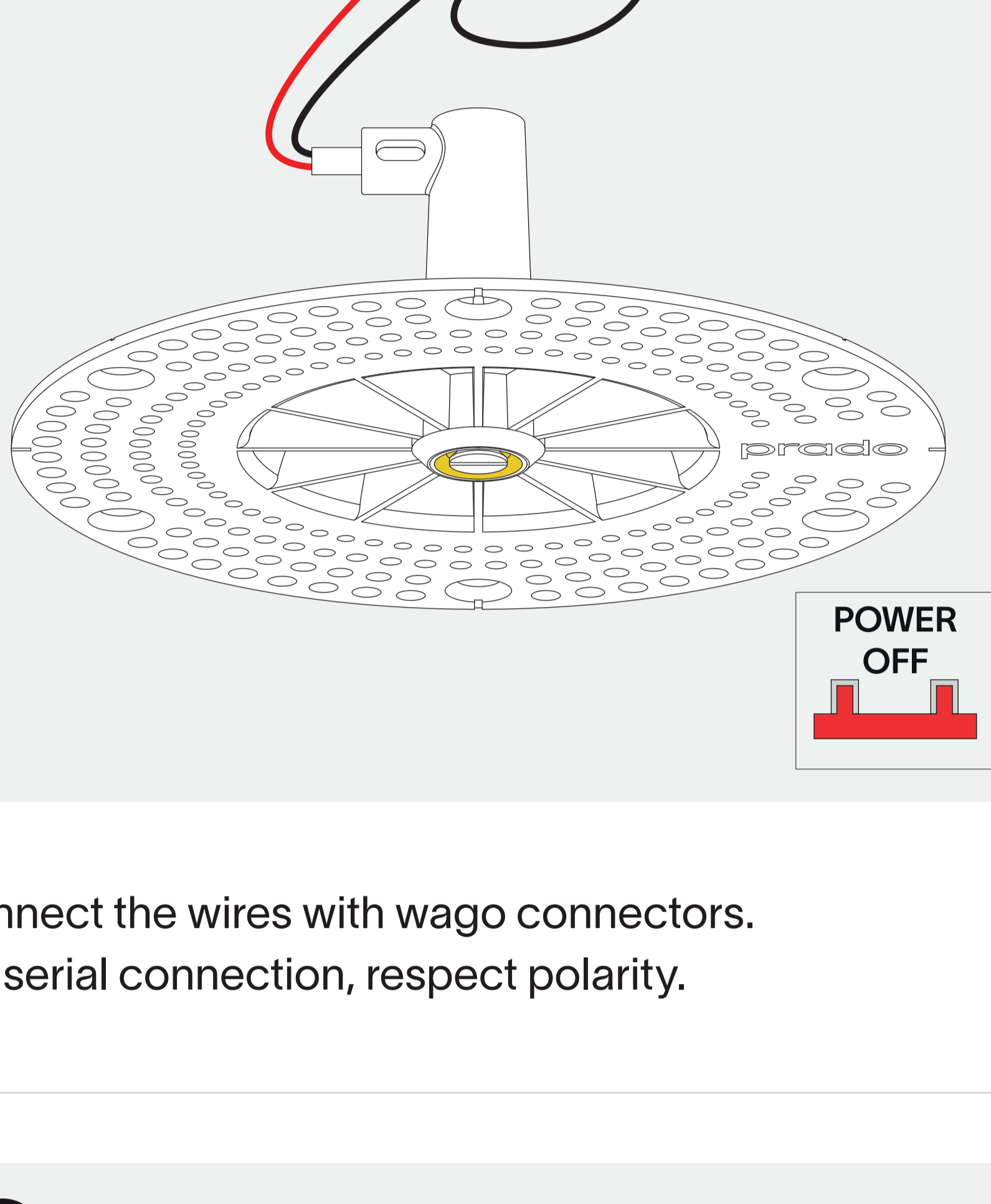

Connect the wires with wago connectors.
For serial connection, respect polarity.

3

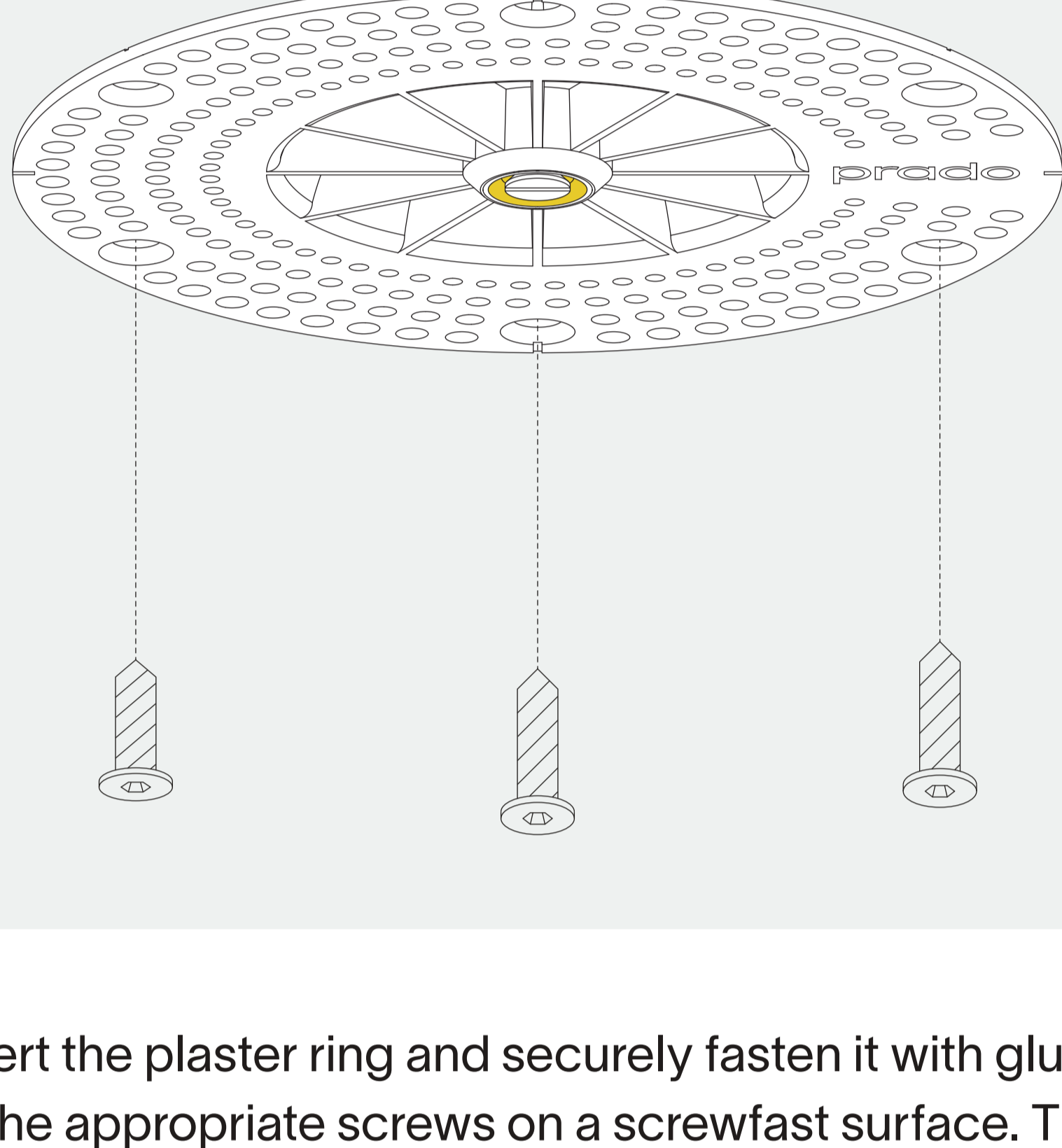

Insert the plaster ring and securely fasten it with glue or the appropriate screws on a screwfast surface. The attachment must be able to obtain a static load of 5 kg. It's the installers responsibility to ensure optimal attachment. We advise to test the electrical connection before starting to plaster.

4

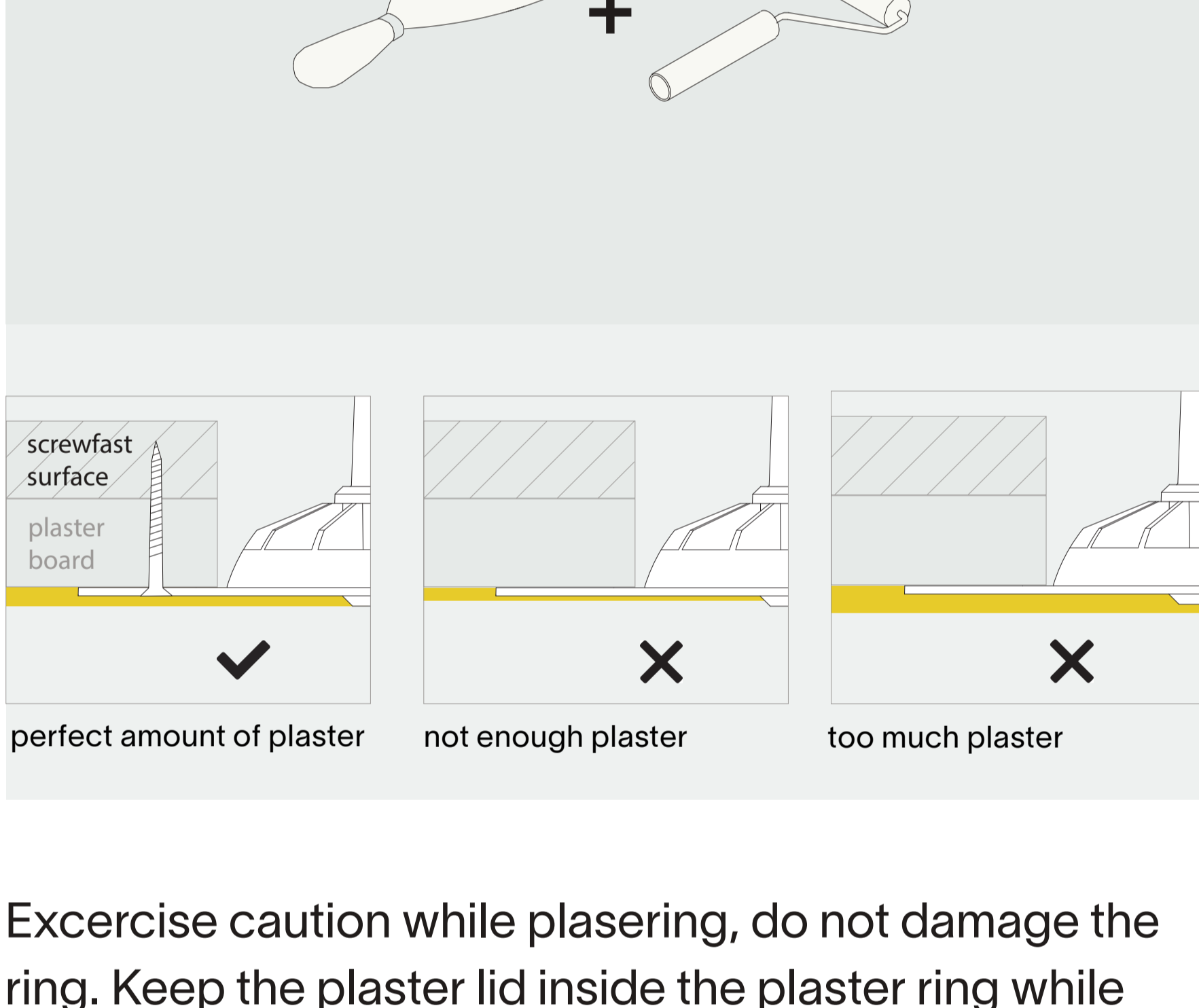

Excercise caution while plasing, do not damage the ring. Keep the plaster lid inside the plaster ring while plastering. Use a fiberglass mesh tape for optimal plaster adhesion. Make sure not to touch the edge of the ring when sanding.

5



Carefully remove excess plaster to access the screw.
You can easily locate the jack kit by using a magnet.

6

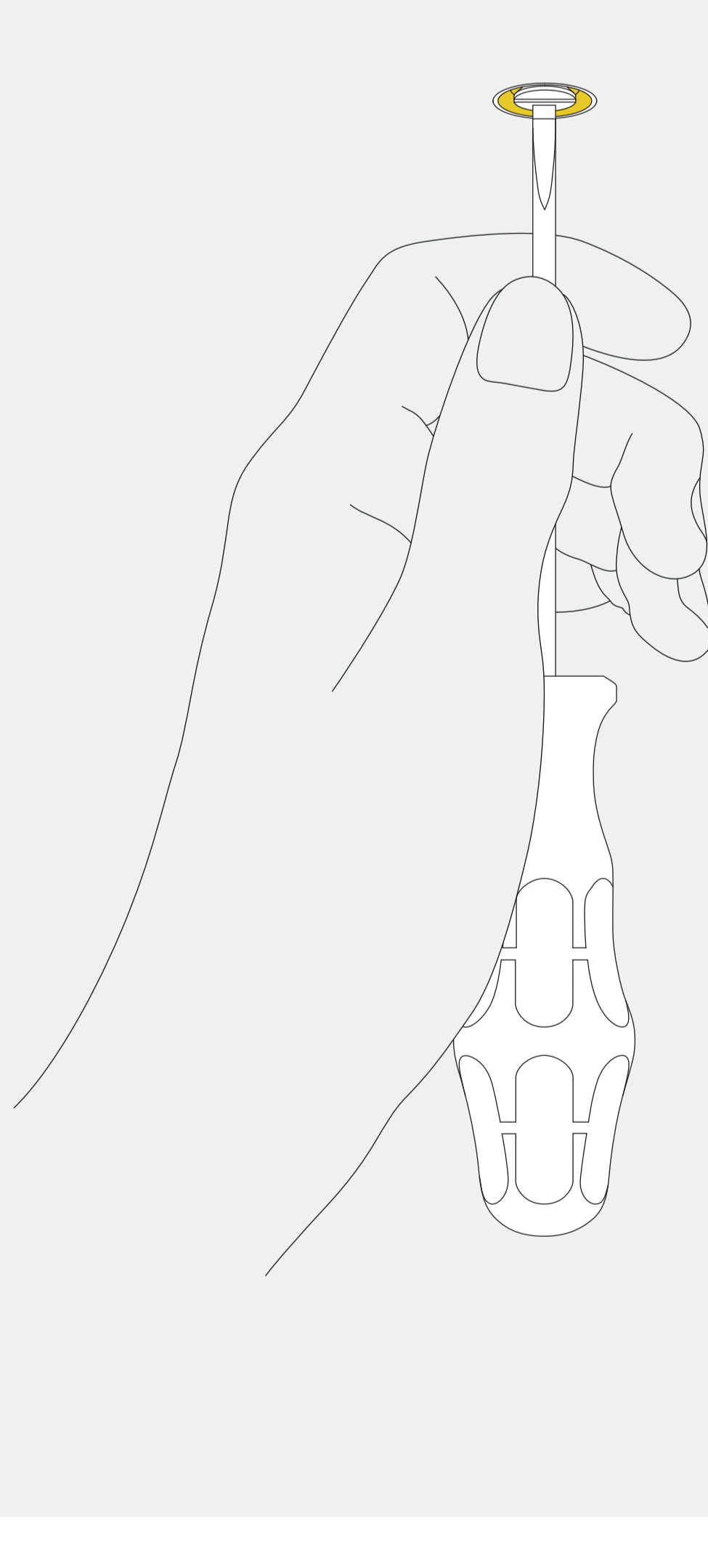

Twist the yellow plaster lid with a screwdriver before removing it with a magnet.

7

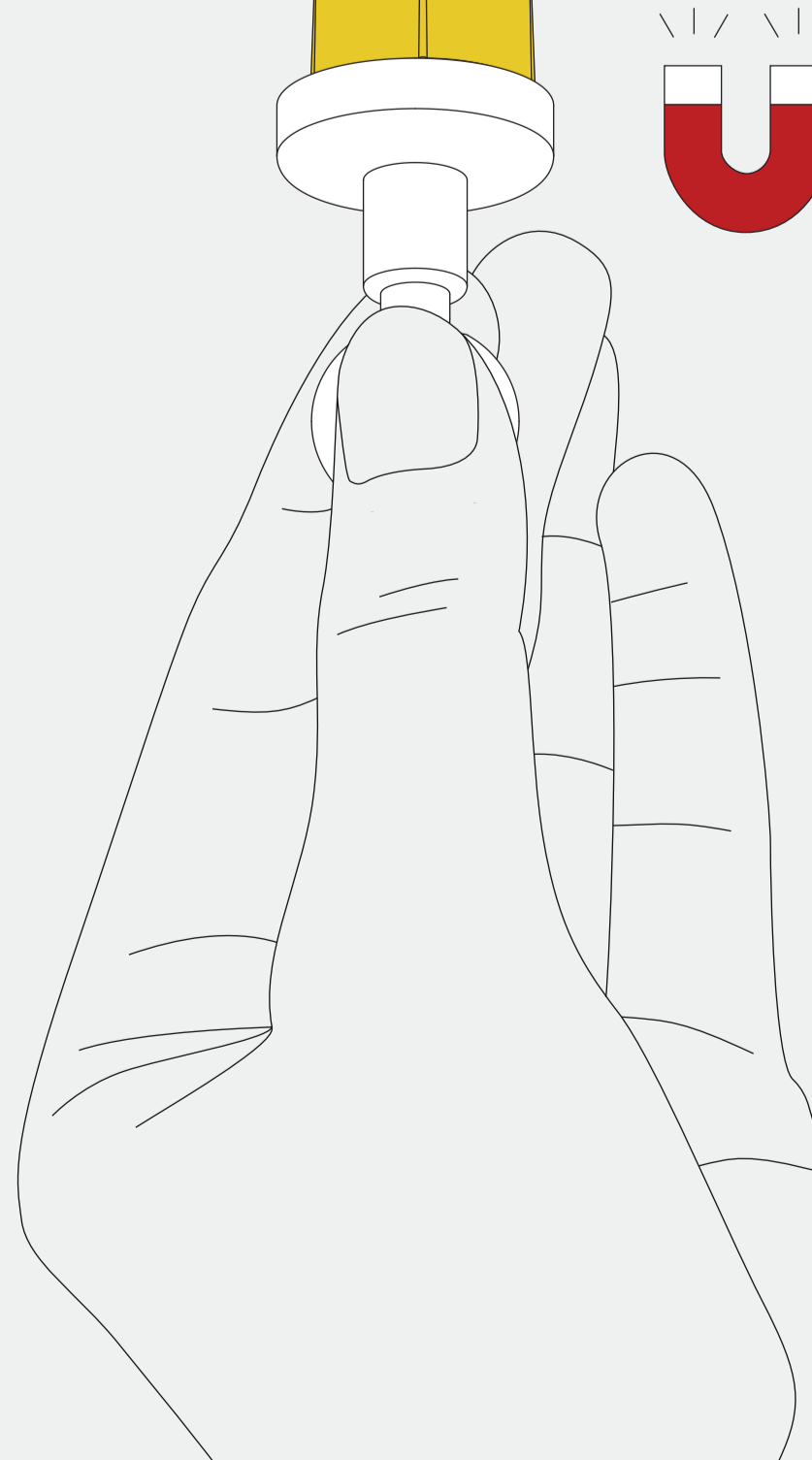

Remove the plaster lid with a magnet before installing the fixture. Any residue needs to be removed without damaging the edges of the installation ring.

thank you for choosing prado